

# PEARL DRUM PEDAL

## P-920

### Instruction Manual

Congratulations on your purchase!  
To get optimum performance of your "P-920" Drum Pedal,  
please read this Instruction Manual before playing.

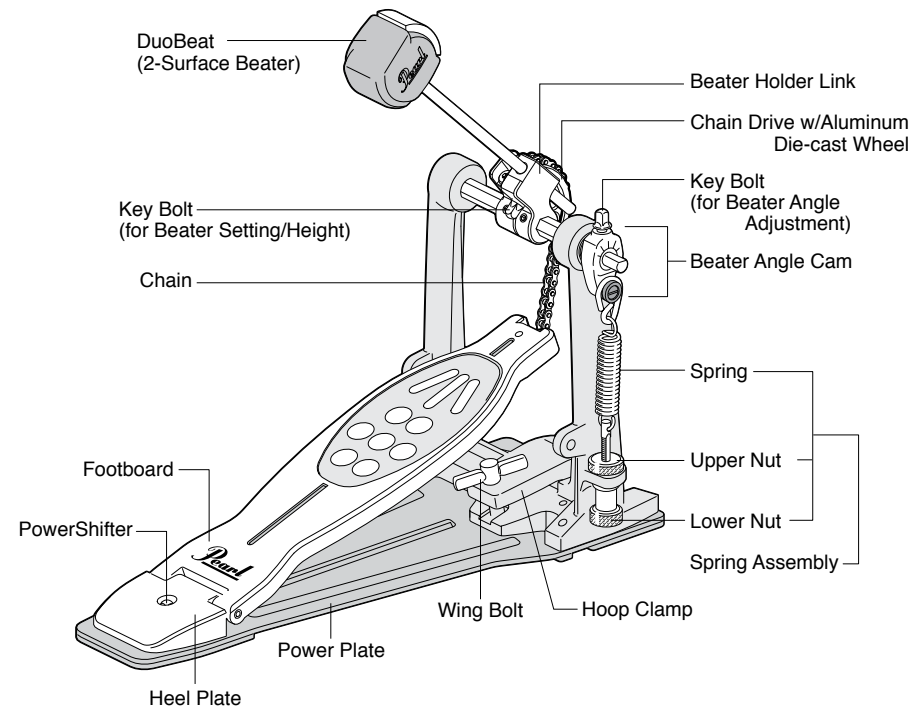

#### Beater Setting

Insert the DuoBeat Beater into the Beater Holder Link with the desired face toward the bass drum head. Tighten the Key Bolt with a Tuning Key to secure at your desired height (Fig.1).

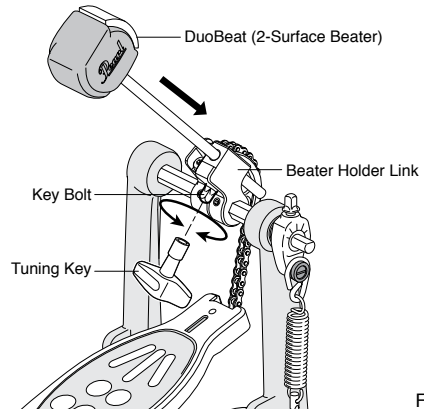

Fig.1

#### Beater Angle Adjustment

The beater angle can be adjusted by loosening the Key Bolt on the Beater Angle Cam. Adjust to desired setting and tighten Key Bolt to secure (Fig.2). For small incremental changes or to index settings use the Gauge located on the Beater Angle Cam.

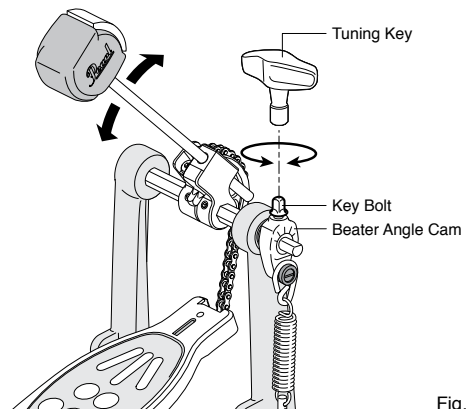

Fig.2

#### DuoBeat

The DuoBeat Beater features a Felt Surface (A) for a full, warm sound and a Plastic Surface (B) for a sharper, punchier sound. Use the side that best suits your playing style (Fig.3).



Fig.3

Surface	A	B
Surface Material	Felt	Plastic
Sound	Full, Warm Sound	Shaper, Punchier Sound

#### Spring Tension Adjustment

To adjust the spring tension, first loosen the Upper Nut. To increase spring tension, turn the Lower Nut clockwise. To decrease spring tension turn the Lower Nut counter-clockwise. Once desired spring tension is achieved, tighten the Upper Nut against pedal frame firmly. Before playing, make sure that both Upper and Lower Nuts are tight (Fig.4).

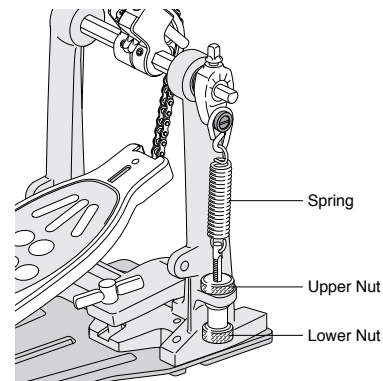

Fig.4

#### Hoop Clamp Wing Bolt

To attach your pedal to the bass drum, slide the bass drum hoop between the Hoop Clamp and the bottom lip of the pedal. Square the pedal and tighten the Wing Bolt to secure (Fig.5).

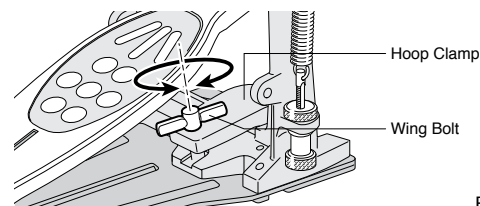
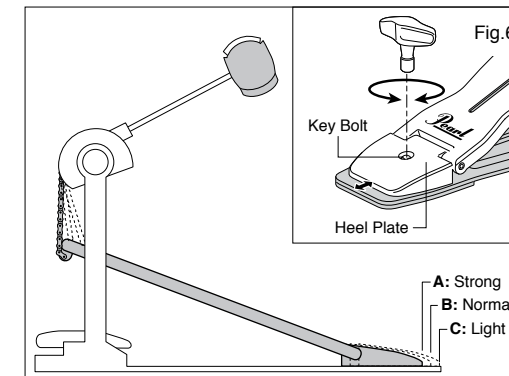

Fig.5

#### PowerShifter

The PowerShifter function allows you to change the feel and action of the pedal by shifting the footboard position back and forth. To change the position, loosen the Key Bolt in the Heel Plate of the footboard and move the footboard to the desired position: A, B or C. Tighten the Key Bolt again (Fig.6).



#### Rubber Mats

To maximize traction of the rubber mats underneath the Power Plate keep them clean and dust free using a damp cotton towel.

#### CAUTION

- Periodically check all Allen Screws for tightness and tighten them with the provided Allen Wrenches as needed.
- Periodically apply lube to all moving parts such as the Chain, Cam Roller, Footboard Hinge, etc. for optimal speed and extended life of your pedal. Bearings should be lubricated with grease, not liquid oil.

**Pearl**

<http://www.pearldrums.com>

Products and specifications are subject to change without notice.

Printed in China

-1607-